

X=5050

X=5000

X=4950

Y=4950

Y=5000

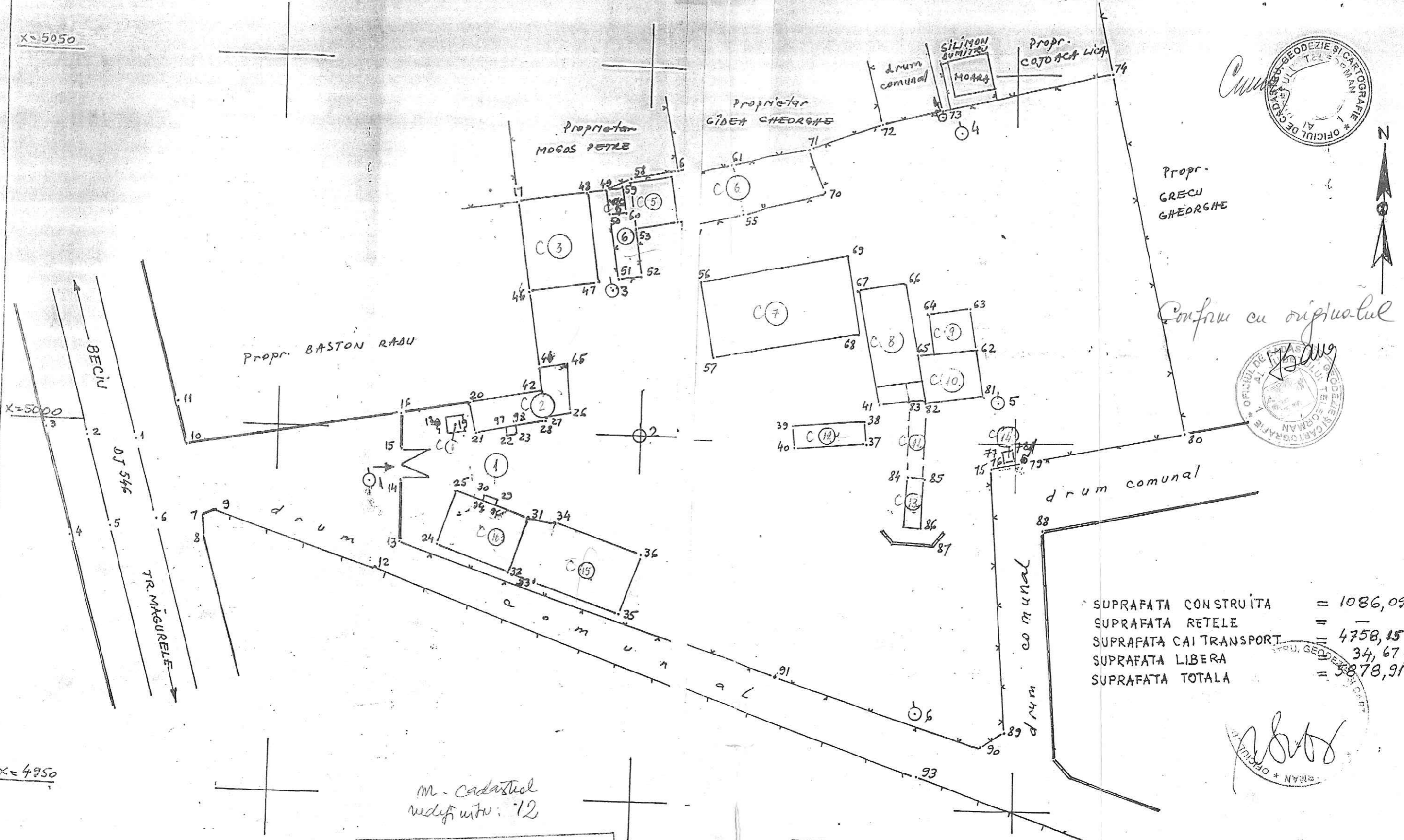

SUPRAFATA CONSTRUITA	= 1086,09 mf
SUPRAFATA RELETE	= -
SUPRAFATA CAI TRANSPORT	= 4758,15 mf
SUPRAFATA LIBERA	= 34,67 mf
SUPRAFATA TOTALA	= 5878,91 mf

ONCGC  
 OFICIUL JUDETEAN DE  
 CADASTRU, GEODEZIE SI  
 CARTOGRAFIE TELEORMAN  
 Nr. inreg. 635 data 23.02.2000  
 VERIFICAT SI RECEPTIONAT:  
 Inspector, *Traus*

M. Cadastrel  
redifinitiv: 12

S.C. "TEL-DRUM" S.A. TELEORMAN			Denumire proiect: Masuratori topo conform H.G. 234/1991	proiect nr
			Beneficiar: S.C. "TEL-DRUM" S.A.	1
Masurat	Th. DINU STELIAN	<i>Traus</i>	1:500	PLAN DE SITUATIE SECTIA LITA
Intocmit	Th. DINU STELIAN	<i>Traus</i>		
Desenat	Th. DINU STELIAN	<i>Traus</i>		
Verificat	Sing. NEASA FLORELA			
Aprobat	ing. GURBAN ANDREI			
				plansa nr
				T <sub>0</sub>

